

City of Lakewood, Colorado
 Public Works Department
 Engineering Division
 303-987-7900
 www.lakewood.org

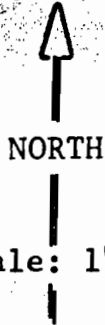

Scale: 1" = 1000'

SECTION BREAKDOWN INFORMATION

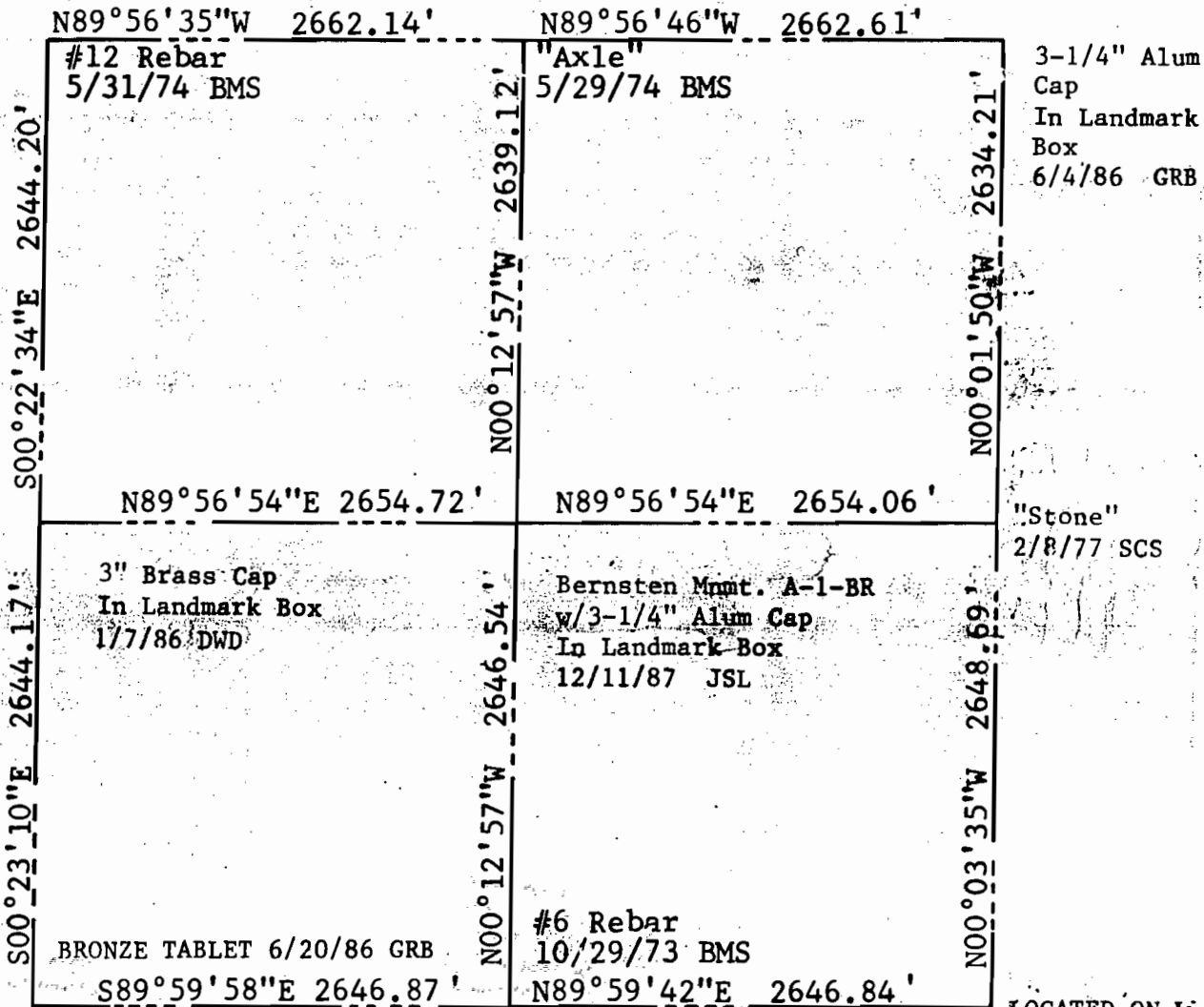

ANGULAR ERROR OF CLOSURE: 0°0'04.5"
 LINEAR ERROR OF CLOSURE AFTER ANGULAR ADJUSTMENT: 0.273'
 TOTAL TRAVERSE LENGTH: 21472.850'
 SURVEY PRECISION: 1/78769
 JOB NO.: FE 0277

SECTION 34, TOWNSHIP 4 SOUTH, RANGE 69 WEST
 DATA BY: Steven C. Steinberger
 DATE: February 1977
 BASIS OF BEARINGS: South line of SW $\frac{1}{4}$ assumed to bear
S89°59'58"E