

City of Lakewood, Colorado
 Public Works Department
 Engineering Division
 303-987-7900
 www.lakewood.org

SECTION 25
 T 4 S, R 69 W
 DATA BY: John Lambert
 DATE October, 1983
 JOB NO. AP2081
 SCALE 1" = 1000'

SECTION BREAKDOWN INFORMATION

#11 rebar W/ 2-1/2" dia. aluminum cap in landmark box 5-18-78 DP #11 rebar W/ 2-1/2" dia. aluminum cap in landmark box 5-18-78 DP #11 rebar W/ 2-1/2" dia. aluminum cap in landmark box 8-01-78 DP

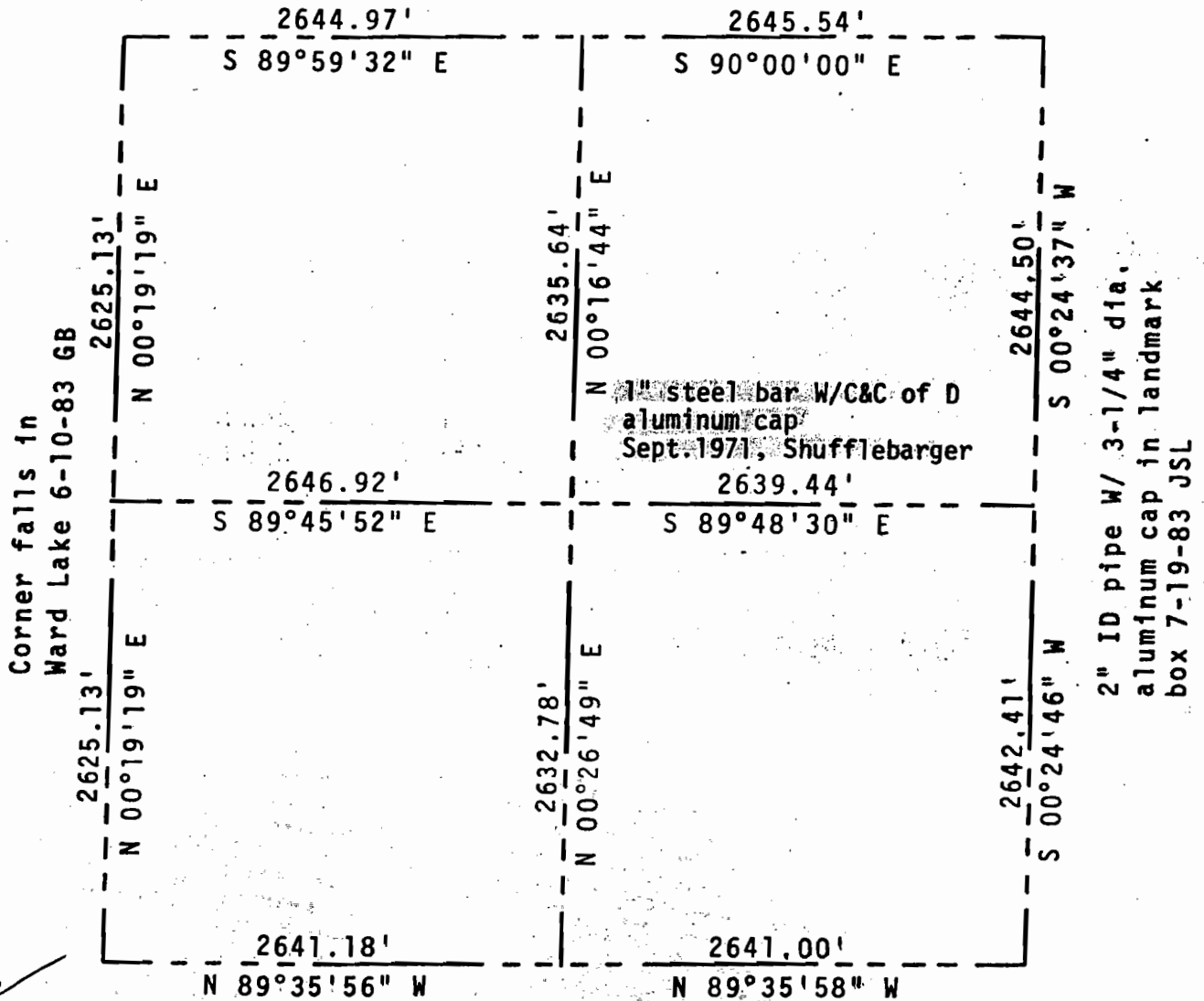

Alum Cap In C & C of Denver Landmark Box 1/25/71 CG 1" steel pin W/aluminum cap in landmark box Sept. 1971 Shufflebarger 2" ID pipe W/ 3-1/4" dia. aluminum cap in landmark box 7-19-83 JSL

ANGULAR ERROR OF CLOSURE: 00°00'29.5"
 LINEAR ERROR OF CLOSURE AFTER ANGULAR ADJUSTMENT: 00.17'
 TOTAL TRAVERSE LENGTH: 22,851.44'
 SURVEY PRECISION: 1:134561
 BASIS OF BEARINGS: North line of NE quarter, Sec.25, T4S, R69W assumed as S 90°00'00" E